

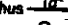

LEGEND
 " or in. means inch or inches
 ' or ft. means foot or feet
 No. means number
 C.L. means Center Line
 E.L. means Elevation
 8" Vitrified Pipe Sewer to be Constructed Shown Thus 
 8"x4" Wyes with 4" Connecting Sewers to be Constructed Shown Thus 
 Manholes to be Constructed Shown Thus 
 Existing Flush Tank to be Converted to Manhole Shown Thus 

SEWER DETAIL
 Lineal ft. of 8" Vitrified Pipe Sewer to be Constructed _____ 1172'
 Lineal ft. of 4" Vitrified Pipe Sewer to be Constructed _____ 940'
 No. of 8"x4" Wyes with 4" Connecting Sewers to be Constructed _____ 32
 No. of Manholes to be Constructed _____ 5
 No. of Existing Flush Tanks to be Converted to Manholes _____ 1

TITLE TO STREETS
 ELEVENTH STREET dedicated by Deed Recorded in
 BOOK of PAGE
 203 211
 537 146

GRADE RESOLUTION
 Grade of ELEVENTH STREET was Established by Resolution No. 2422
 Grade of PICO AVENUE was Established by Resolution No. 2422

DATUM
 All elevations shown are in feet and are above a plane
 which is 1045.28 feet below the City Bench Mark as
 established by Ordinance 383 of the City of SAN
 BERNARDINO, CALIFORNIA

NOTE
 All Vitrified Pipe Connecting Sewer Shall be
 Constructed on an Upward Grade of Two
 Per Cent from Main Sewer and Shall extend
 from Main Sewer to the Property Line



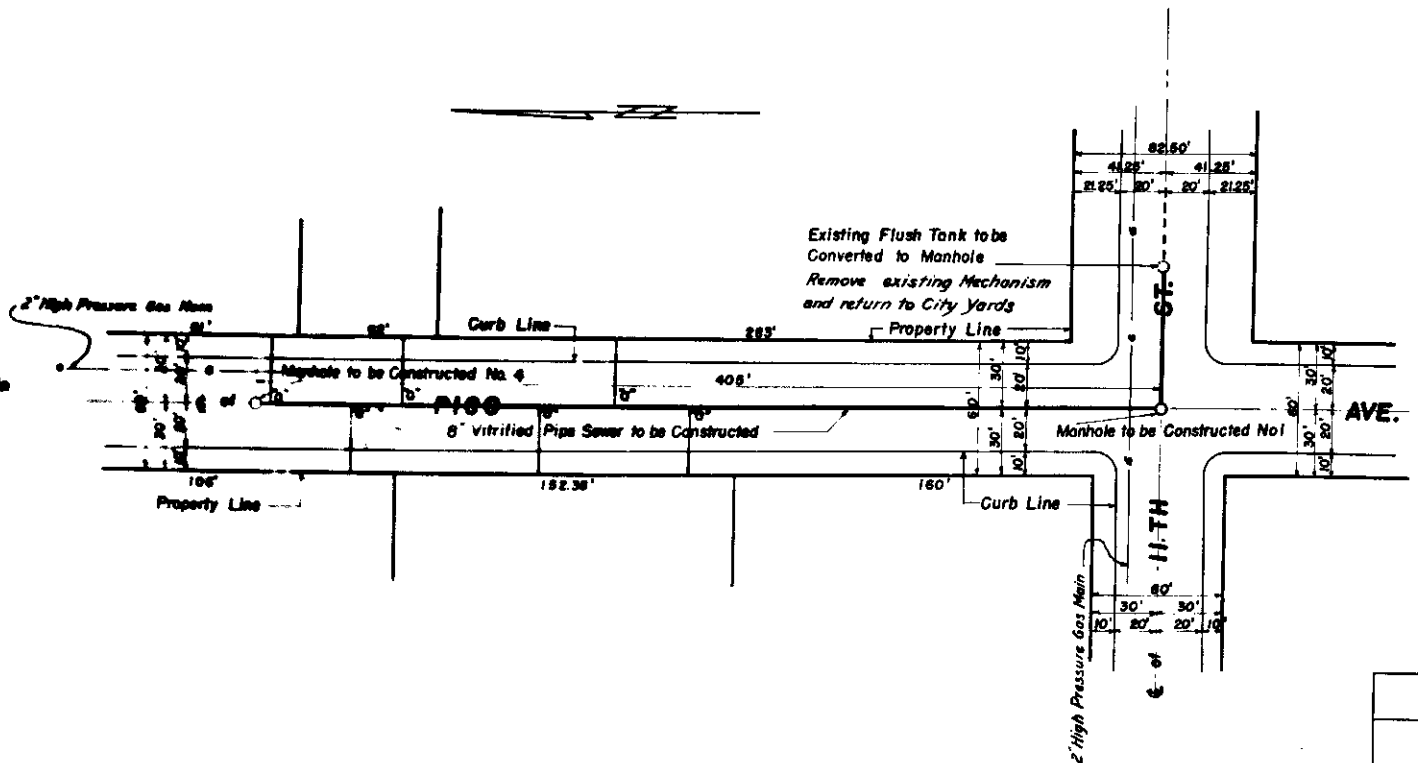
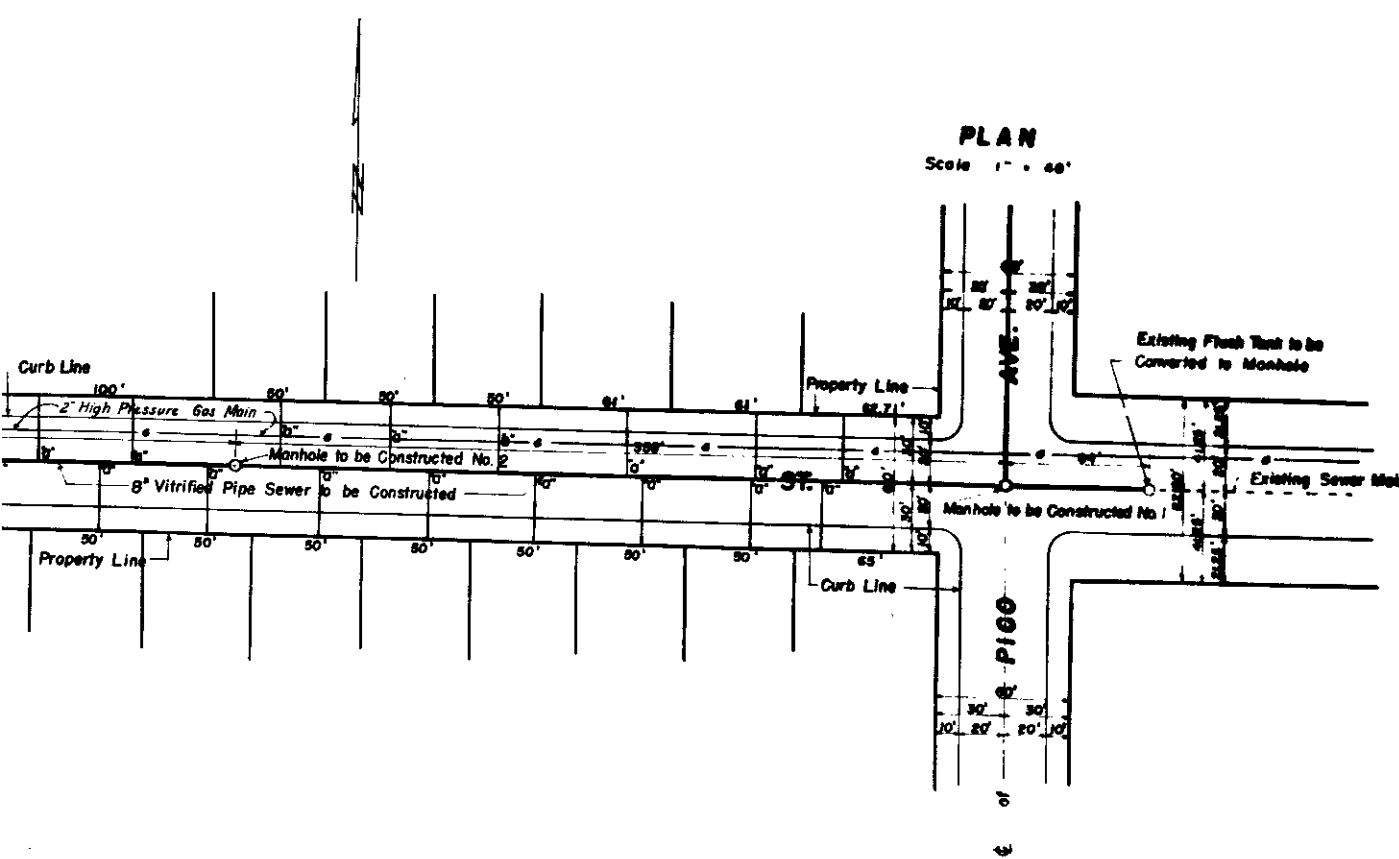

PROFILE
 Scale Horiz. 1" = 40'
 Vert. 1" = 4'

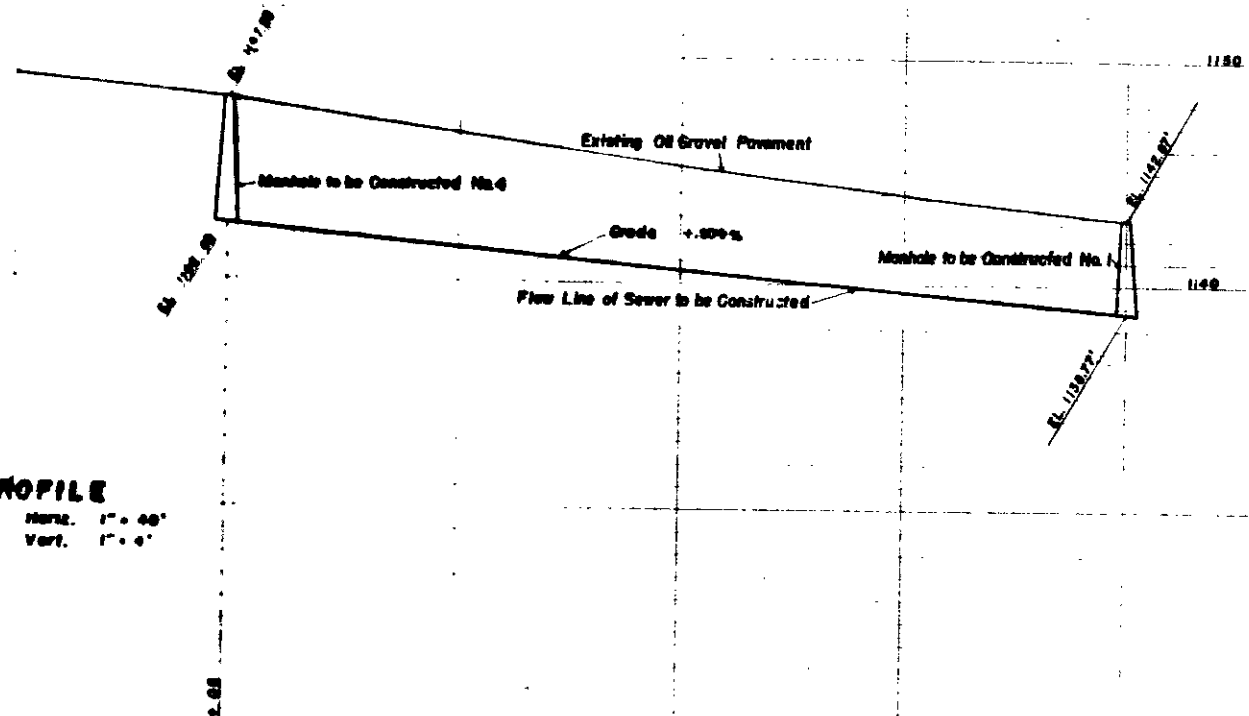
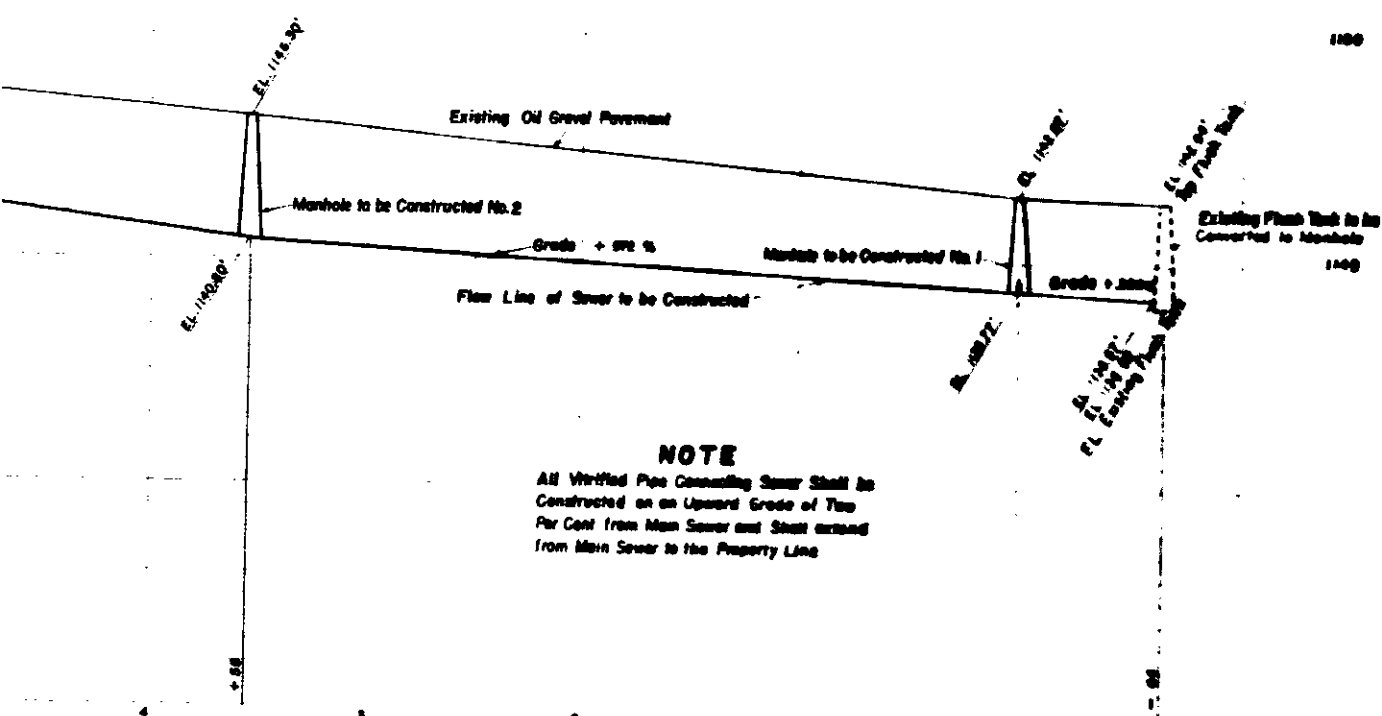

DEPARTMENT OF ENGINEERING
 CITY OF SAN BERNARDINO
 ELEVENTH STREET
 FROM PICO AVENUE TO 710' WEST
 PICO AVENUE
 FROM 11TH ST. TO 405' NORTH
 SEWER

11TH ST. TO 710' WEST PICO AVE. TO 405' NORTH



LEGEND
 " or in. means inch or inches
 ' or ft. means foot or feet
 No. means number
 C.L. means Center Line
 E.L. means Elevation
 8" Vitrified Pipe Sewer to be Constructed Shown Thus 
 8"x4" Wyes with 4" Connecting Sewers to be Constructed Shown Thus 
 Manholes to be Constructed Shown Thus 
 Existing Flush Tank to be Converted to Manhole Shown Thus 

SEWER DETAIL
 Lineal ft. of 8" Vitrified Pipe Sewer to be Constructed 1172'
 Lineal ft. of 4" Vitrified Pipe Sewer to be Constructed 940'
 No. of 8"x4" Wyes with 4" Connecting Sewers to be Constructed 32
 No. of Manholes to be Constructed 5
 No. of Existing Flush Tanks to be Converted to Manholes 1

TITLE TO STREETS
 ELEVENTH STREET dedicated by Ordinance No. 14527
 BOOK of PAGE
 203 211
 537 146

GRADE RESOLUTION
 Grade of ELEVENTH STREET was Established by Resolution No. 24227
 Grade of PICO AVENUE was Established by Resolution No. 24228

DATUM
 All elevations shown are in feet and are above a plane which is 1045.28 feet below the City Bench Mark as established by Ordinance 383 of the City of SAN BERNARDINO, CALIFORNIA

NOTE
 All Vitrified Pipe Connecting Sewer Shall be Constructed on an Upward Grade of Two Per Cent from Main Sewer and Shall extend from Main Sewer to the Property Line

PROFILE
 Scale Horiz. 1" = 40'
 Vert. 1" = 4'

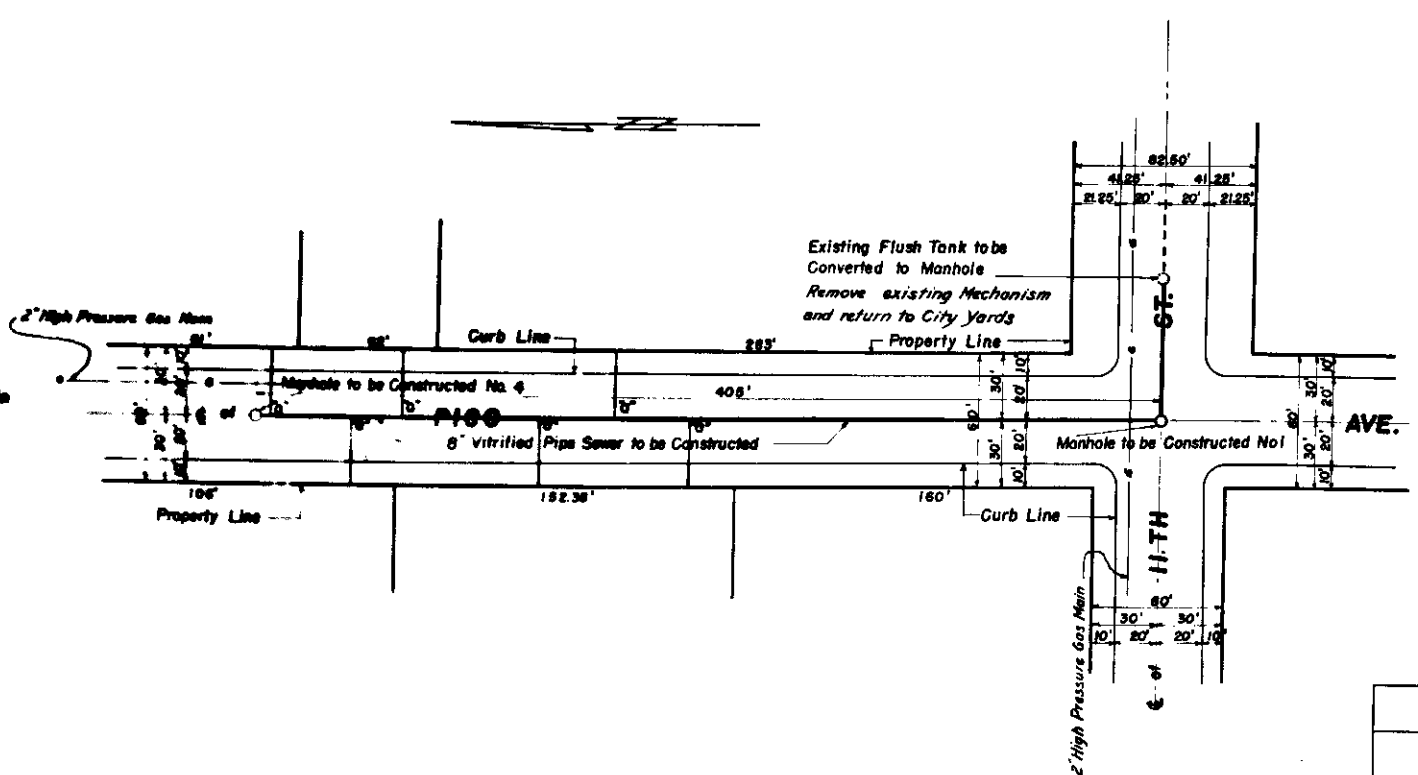
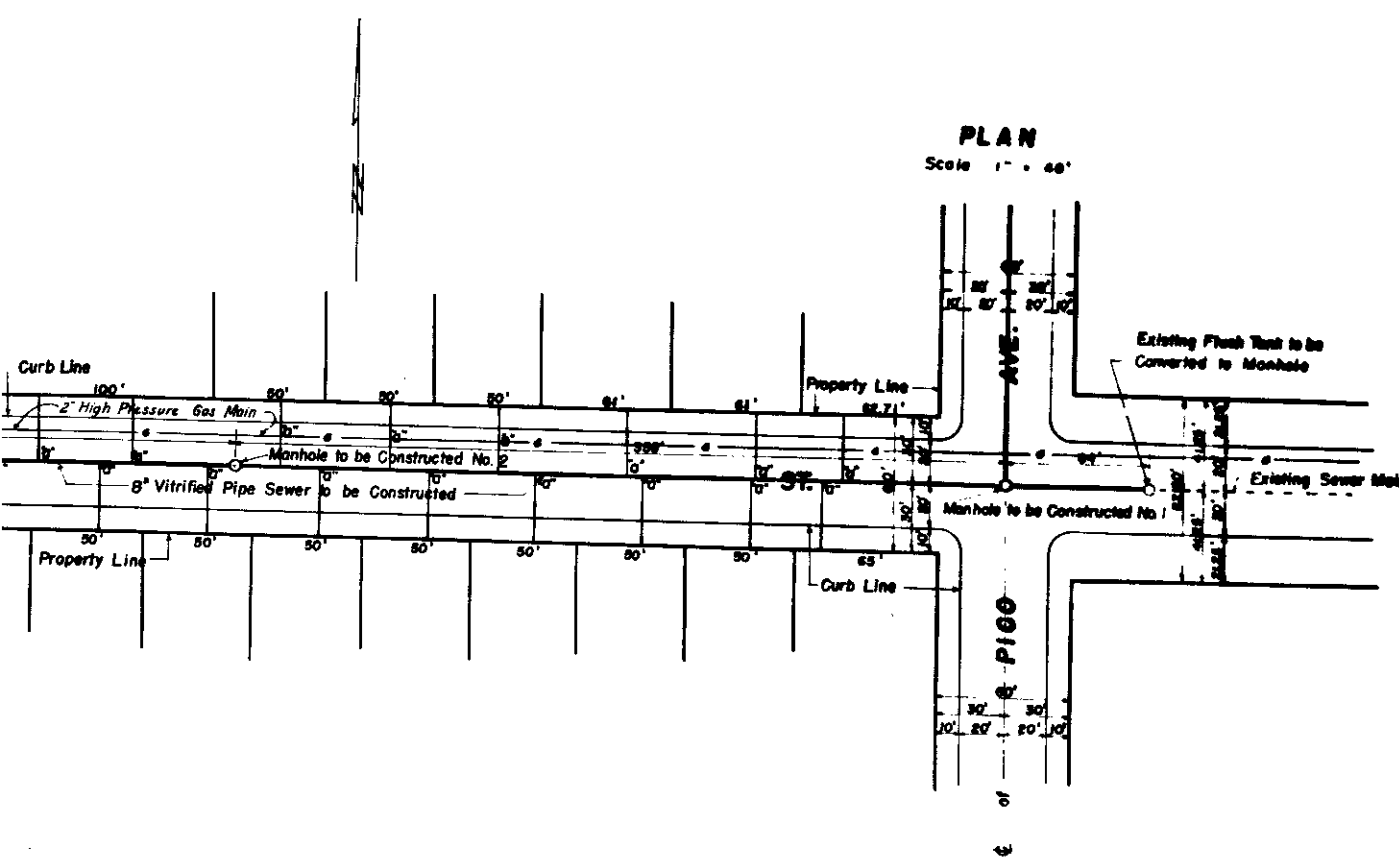

DEPARTMENT OF ENGINEERING
 CITY OF SAN BERNARDINO
 ELEVENTH STREET
 FROM PICO AVENUE TO 710' WEST
 PICO AVENUE
 FROM 11TH ST. TO 405' NORTH
 SEWER

11TH ST. TO 710' WEST PICO AVE. TO 405' WEST